

## Adjustment options

### Octagonal bolt

Regulate the contact pressure between the sash and the frame ( $\pm 0.8$  mm) by turning the octagonal bolt. The adjustment can be carried out by means of the Winkhaus adjustment key (V.SCH.ACP-S).

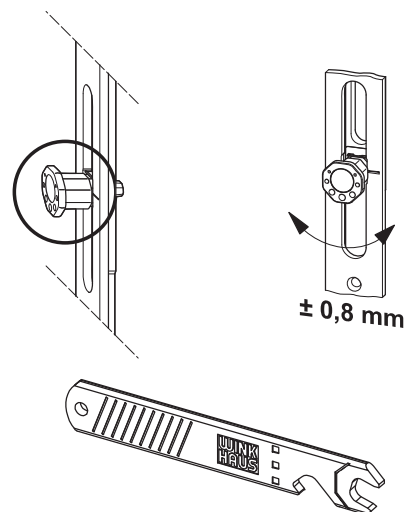

Octagonal bolt

### Shears

The sash is raised and lowered by adjusting the shear slideway. The sash can be raised 2.5 mm and lowered 1.5 mm.

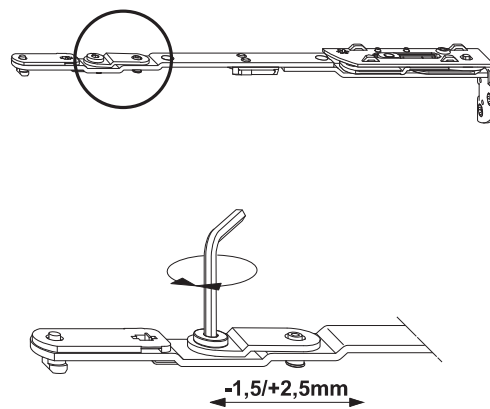

Shears

### Corner hinge up to a sash weight of 100 kg

Height adjustment (+ 3 mm / -2 mm) and side adjustment ( $\pm 2$  mm) for the sash hinge.

Pressure adjustment: +/- 0.8 mm

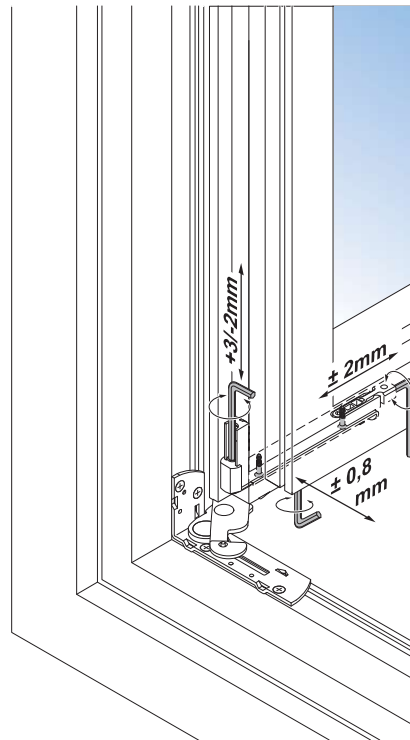

Corner hinge up to a sash weight of 100 kg

### Corner hinge more than 100 kg sash weight.

Height adjustment (+ 3 mm / -2 mm) and side adjustment ( $\pm 2$  mm) for the sash hinge.

Pressure adjustment: +/- 0.8 mm



Note: The sash hinge adjusting screw must be removed first. Loads are transferred by the Sash Hinge Rail!

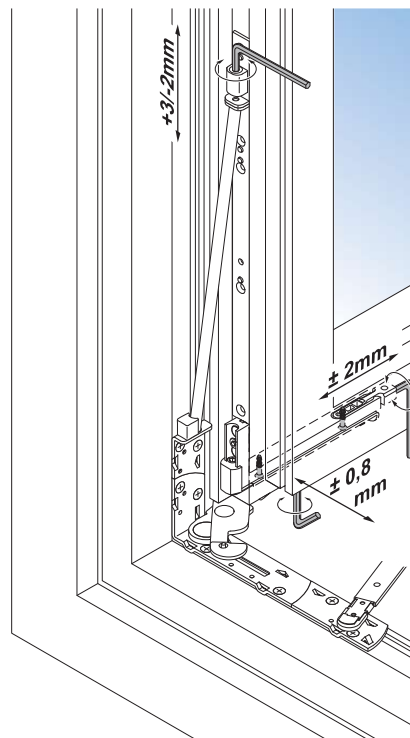

Corner hinge more than 100 kg sash weight.

1  
General product information

2  
Lists of Fittings

3  
Drive rods

4  
Corner drives

5  
Top rods

6  
Sash hinges/  
Corner hinges

7  
Shears/  
Shear hinges

8  
Turn hinges/  
Tilt hinges

9  
Extension rods

10  
Accessories

11  
Frame parts

12  
Mounting accessories

13  
Mounting instructions

14  
Adjustment/  
maintenance

15  
Installation drawings

16  
activPilot Select

# 1 Adjustment and maintenance

## 2 Dual/triple function element

### 3 DFE/TFE activation

The DFE/TFE element is supplied in the neutral position. Please proceed as follows:

Drive in the protruding pin to fix in place (1).

Non-handed by swivelling out the lever once only.

Dribble a few drops of oil (free of resin and acid) onto lubrication points.

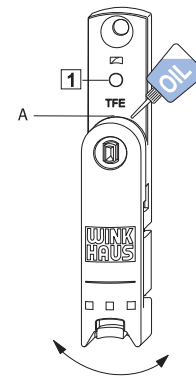

DFE/TFE activation

### 8 TFE – Retaining force of balcony door catch

Adjusting the holding force by re-setting the eccentric cam with a 4 mm Allen key.

Dribble a few drops of oil (free of resin and acid) onto lubrication points.

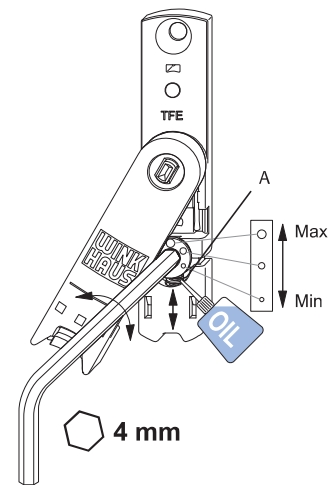

TFE – Retaining force of balcony door catch

### 14 Frame part DFE/TFE

Height adjustment ( $\pm 3$  mm) for sash support plate.

Each time fittings are adjusted, the DFE/TFE height setting should also be checked using a 2.5 mm Allen key.

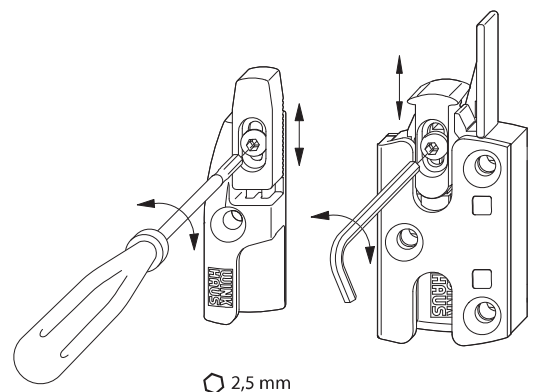

Frame part DFE/TFE

# Maintenance

## Lubrication points

See figure: Overview of lubrication points

The figure shows the location of possible lubrication points which should be lubricated at least once a year.

Positions A, C, D = lubrication points relevant to function.

Position B = safety-relevant lubrication point



Please note: The fitting schematic shown adjacent does not necessarily match the existing fitting. The number of locking positions will vary depending on size and type of the window sash.

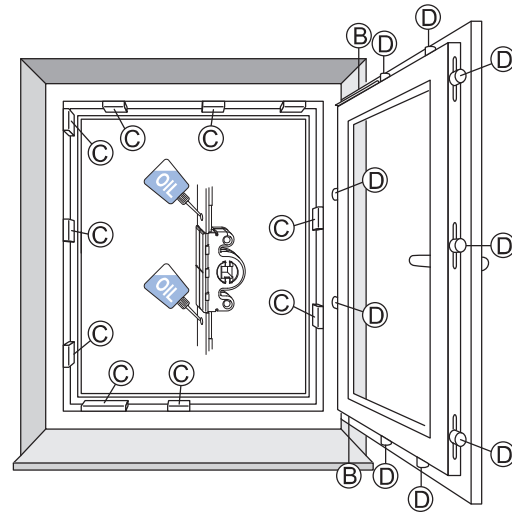

Overview of lubrication points



Attention! Risk of injury. The window could fall on removal and thus injure persons. Do not remove the window for maintenance.

## Keeps

See figure: Lubrication points

To keep fittings running smoothly, you must lubricate the keeps once a year.

- Lubricate the keeps (C) at the run-in side with technical Vaseline or any other suitable grease.
- Coat the running surfaces of the locking bolts (D) with an oil that is free of resins and acids.

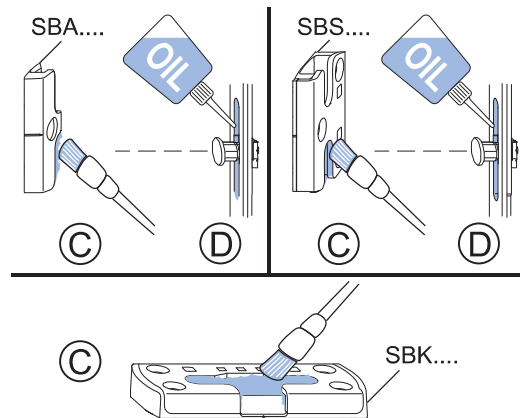

Lubrication points

## Ascertaining the run-in sides

See figure: Run-in sides

- Left-handed window; handle right
- Right-handed window; handle left

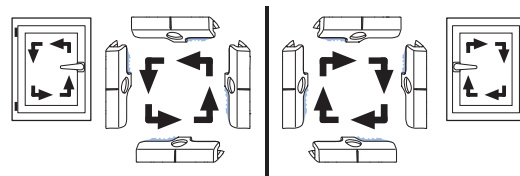

Run-in sides

- 1 General product information
- 2 Lists of Fittings
- 3 Drive rods
- 4 Corner drives
- 5 Top rods
- 6 Sash hinges/ Corner hinges
- 7 Shears/ Shear hinges
- 8 Turn hinges/ Tilt hinges
- 9 Extension rods
- 10 Accessories
- 11 Frame parts
- 12 Mounting accessories
- 13 Mounting instructions
- 14 Adjustment/ maintenance
- 15 Installation drawings
- 16 activPilot Select

## Lubrication points

### Shear and corner hinge

See figure: Shear (sash/frame), corner hinge, sash hinge rail

Fitting parts are to be tested regularly (at least once annually or semi-annually in school and hotel construction) to ensure they are seated firmly and checked for wear. Fastening screws are to be retightened and parts replaced as necessary. Their functionality is to be retested afterwards.

All moving contact points on the shear and the corner hinge should be greased with a suitable lubricant on a yearly basis. Coat lubricating points with non-resinous, non-corroding grease.



Attention! Risk of injury. The window could fall on removal and thus injure persons. Do not remove the window for maintenance.

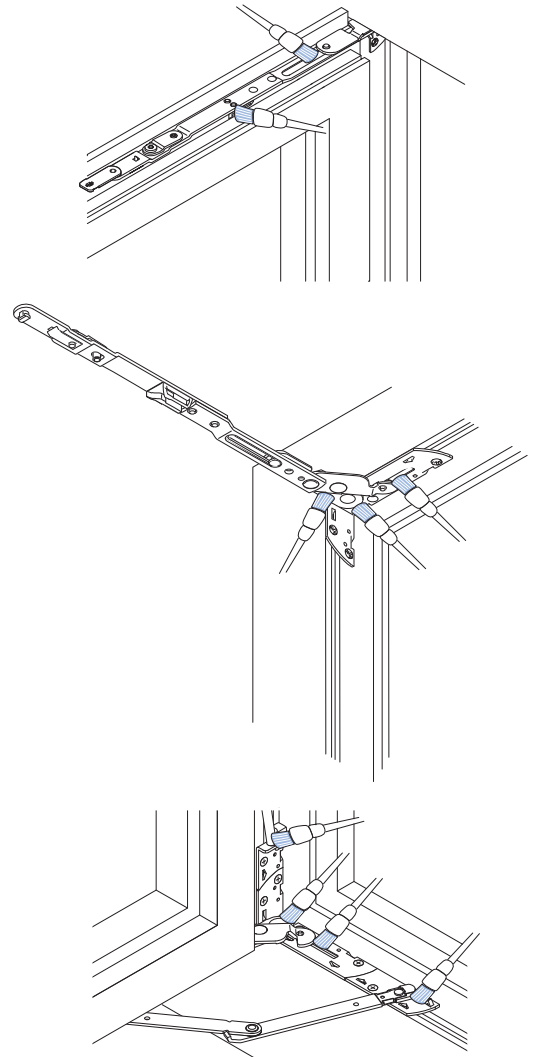

Shear (sash/frame), corner hinge, sash hinge rail